



OUTDOOR GAS FIREPLACES, FIRE PITS, & NATURAL GAS GRILLS

A building permit is required for all outdoor appliances that use natural gas supplied from the building gas meter. Complete the general permit application form to be submitted to the Broomfield Building Division. Separate permits will be required if different contractors are doing the gas piping and the actual appliance installation. Submit a fully-dimensioned site plan showing the location of the new appliance(s) and a schematic drawing of the gas piping that includes:

- all other gas appliances;
- the input rating in BTU's for all appliances, existing and new; and
- the length, size, and type of material of all gas pipes between the meter and the new appliance(s).

This is required to determine the correct size of piping to serve the proposed appliance without negatively affecting any existing gas outlets. Please note on the site plan if new electrical outlets will be installed to provide power for any new appliances or lighting.

Gas piping installed below grade shall be buried at a depth of not less than 12 inches and shall be protected against corrosion. Piping installed through a foundation wall shall be encased in a protective pipe sleeve; the annular space between the gas pipe and the sleeve shall be sealed. Gas piping installed outside shall be elevated not less than 3½ inches above the ground and shall be protected against corrosion and physical damage.

The gas fireplace, fire pit, or grill shall be listed for exterior use. The manufacturer's instructions shall be followed to determine clearances to any combustible materials including overhead structures such as patio covers.

New gas piping shall be pressure tested in accordance with IRC Section G2417 using a pressure of 10 psi for not less than 10 minutes. Pressurize the section to be tested prior to the arrival of the inspector. Valves shall not be used as a bulkhead between gas in one section of piping and test pressure in an adjacent section; appliances shall be isolated from the piping system by disconnecting them and capping the outlets. Call 303.438.6376 to schedule a gas pipe inspection before any piping is buried or otherwise concealed.

When the installation is complete, you must call for an inspection. The inspector will check the installation and the function of the appliance and any necessary protection of gas piping such as paint. An inspection must also be called for any electrical work performed.



OUTDOOR GAS FIREPLACES, FIRE PITS, & NATURAL GAS GRILLS

Example Drawing of Gas Piping Schematic

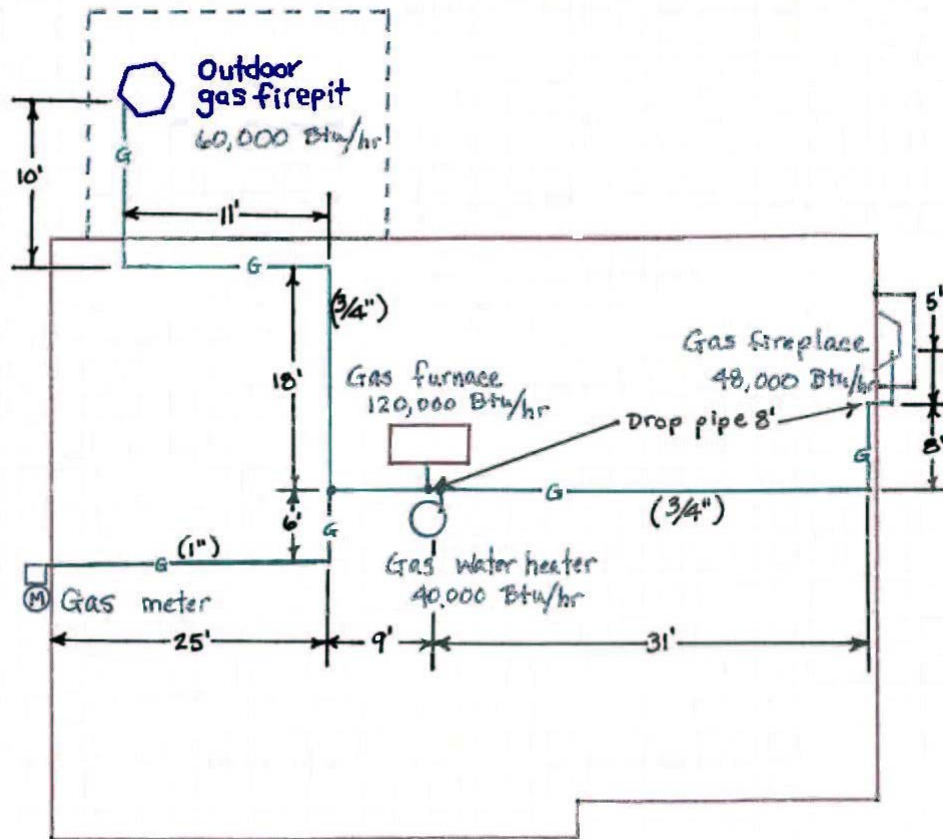

No scale